



37 Pilgrims Way, Laverstock, Salisbury, Wiltshire, SP1 1RZ

*** VIEWINGS ON HOLD DUE TO HIGH DEMAND ***

- Popular location
- Three bedrooms
- Fitted kitchen
- Lounge
- En suite
- Parking
- Gas fired central heating
- Double glazing
- Garage now storage and study

£1,250 PCM

Ground Floor

Approx. 39.6 sq. metres (426.8 sq. feet)

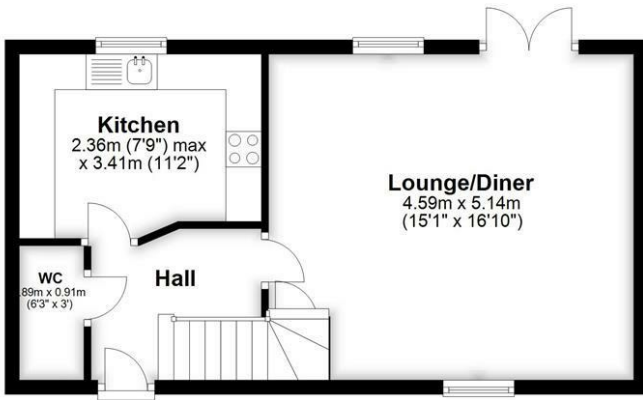

First Floor

Approx. 39.6 sq. metres (426.8 sq. feet)

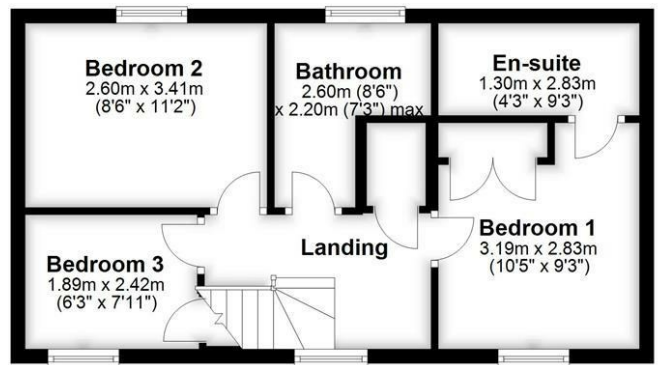

Total area: approx. 79.3 sq. metres (853.6 sq. feet)

WHITES

Castle Chambers, 47 Castle Street, Salisbury,
Wiltshire, SP1 3SP

Tel: 01722 336422/Option 2

www.hwwhite.co.uk

email: lettings-management@hwwhites.co.uk

| Energy Efficiency Rating | | |
|---|---------|-----------|
| | Current | Potential |
| Very energy efficient - lower running costs | | |
| (92 plus) A | | 87 |
| (81-91) B | | |
| (69-80) C | | |
| (55-68) D | | |
| (39-54) E | | |
| (21-38) F | | |
| (1-20) G | | |
| Not energy efficient - higher running costs | | |
| | 75 | |
| England & Wales | | |
| EU Directive 2002/91/EC | | |

| Environmental Impact (CO ₂) Rating | | |
|---|---------|-----------|
| | Current | Potential |
| Very environmentally friendly - lower CO ₂ emissions | | |
| (92 plus) A | | 91 |
| (81-91) B | | |
| (69-80) C | | |
| (55-68) D | | |
| (39-54) E | | |
| (21-38) F | | |
| (1-20) G | | |
| Not environmentally friendly - higher CO ₂ emissions | | |
| | 79 | |
| England & Wales | | |
| EU Directive 2002/91/EC | | |